

Model KG-15 Manual Ship Gong

The Kahlenberg KG-15 Manual Ships Gong is built to withstand decades of use in commercial and military marine service. With the exception of bronze bushings in the operating mechanism, the KG-15 is built entirely from stainless steel including the mounting bracket assembly. Manually operated with a stainless pull lanyard, the KG-15 Bell is a simple but effective solution to meet International IMO and COLREG requirements for a gong (in addition to ship's bell) sounding at a minimum of 110 dB(A) on all vessels over 100 meters in length.

TECHNICAL DATA

S.P.L.: 110 dB (A)

Material: Stainless Steel

Net Weight: 18 lbs. (8.2 kg)

Dimensions: 15" Dia. X 6.52"
(381 mm Dia. X 166 mm)

Operating Mechanism: Manual Pull Lanyard



- **STAINLESS STEEL LOW PROFILE CONSTRUCTION**
- **FOR VESSELS OVER 75 METERS IN LENGTH**
- **MEETS OR EXCEEDS IMO AND USCG REQUIREMENTS**
- **HIGHLY RELIABLE, VIRTUALLY NO MAINTENANCE**
- **MANUALLY OPERATED**

REV.	BY	DATE	DESCRIPTION	APP'D.

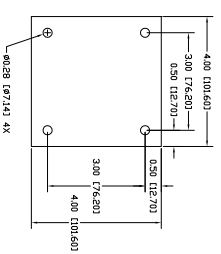
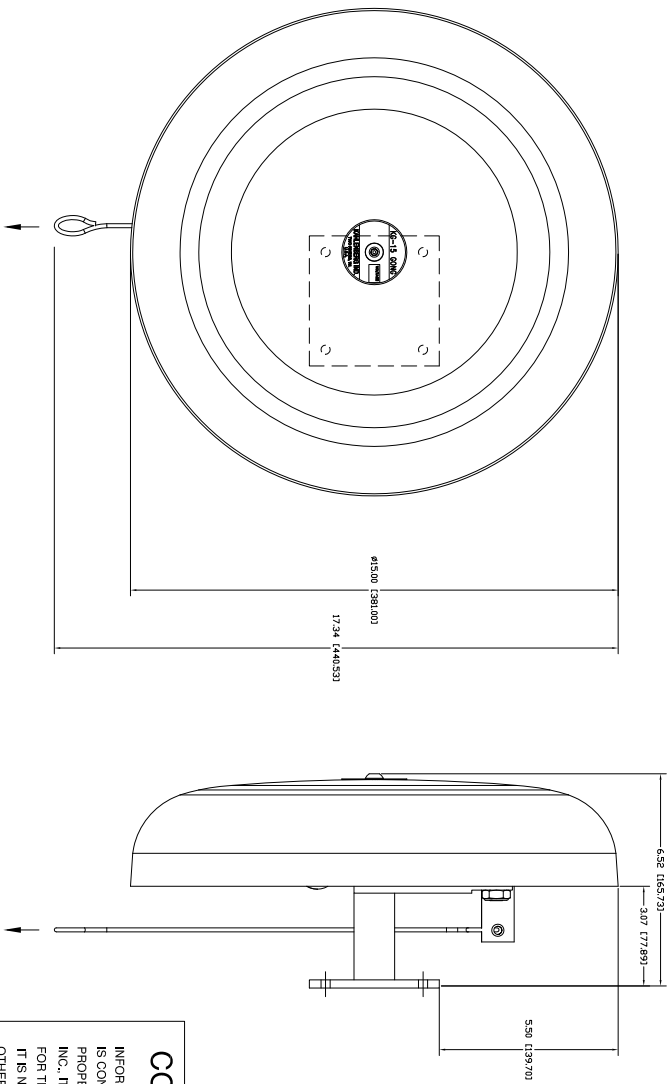
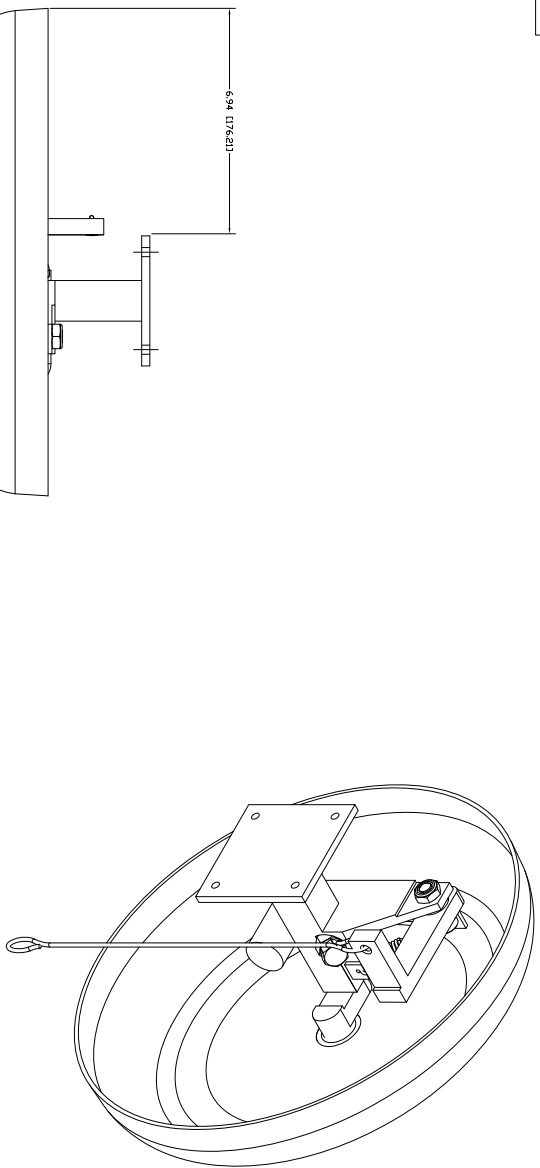

MECHANICAL GONG
 MATERIAL: STAINLESS STEEL
 DB: 110DBA @ 1m
 WEIGHT: 18.05 Lbs./8.19 Kg

CONFIDENTIAL

INFORMATION CONTAINED HEREIN IS CONFIDENTIAL. IT IS THE PROPERTY OF KAHLEBERG INDUSTRIES INC. IT IS TO BE USED SOLELY FOR THE PURPOSE PROVIDED, AND IT IS NOT TO BE DISCLOSED TO OTHERS WITHOUT THE PRIOR WRITTEN CONSENT OF KAHLEBERG INDUSTRIES INCORPORATED.



KAHLEBERG INDUSTRIES INC. TWO RIVERS, WISCONSIN 54241

**OUTLINE DIMENSIONS
 KG-15 SHIPS GONG**

DR.	DATE	CKD.	SCALE	DRWG. NO.	REV.
ZJN	03/05/14	EMK	N.T.S.	3-6833	