

### Model D-4A Yacht Horn

Kahlenberg Chimetone Air Horns all utilize more than one projector or “trumpet” in their design. These projectors each produce a different fundamental frequency which combine to produce powerful, distinctive, musical chords. To hear a Chimetone Air Horn is to realize that the sound of a vessel can be one of its most impressive aspects. The Model D-4A Air Horn is designed for the largest yachts over 75 meters in length. It is made entirely of bronze and brass, and is available in triple chrome plate finish as well as a variety of other optional finishes.



- FOR VESSELS 75 TO 200 METERS IN LENGTH
- MEETS OR EXCEEDS IMO REQUIREMENTS
- THE BEST SOUND IN A WIDE VARIETY OF FINISHES
- HIGHLY RELIABLE

#### TECHNICAL DATA

Fundamental Frequency: 171, 220 Hz

S.P.L. : (1/3 Octave @ 1 Meter): 138 dB

Air Consumption:

116 C.F.M. @ 150 p.s.i., 55 l/s @ 10 bar

Air Pressure Required:

100 to 250 p.s.i., 7 to 17 bar  
(Higher pressures with optional regulators)

Electrical Power Required:

Any standard A.C. or D.C. Voltage

Material: Cast Bronze and Naval Brass

Net Weight: 145 lbs., 65 kg.,

Finish:

Kahlenberg Chrome Plate, TGIC Sky  
White Powdercoat, Gold or Black  
Chrome PVD, Chrome Nitride

Dimensions:

25" x 24" x 13" (635x612x330mm)

Conforming to International Maritime Regulations  
For Vessels Between 75 & 200 Meters in Length

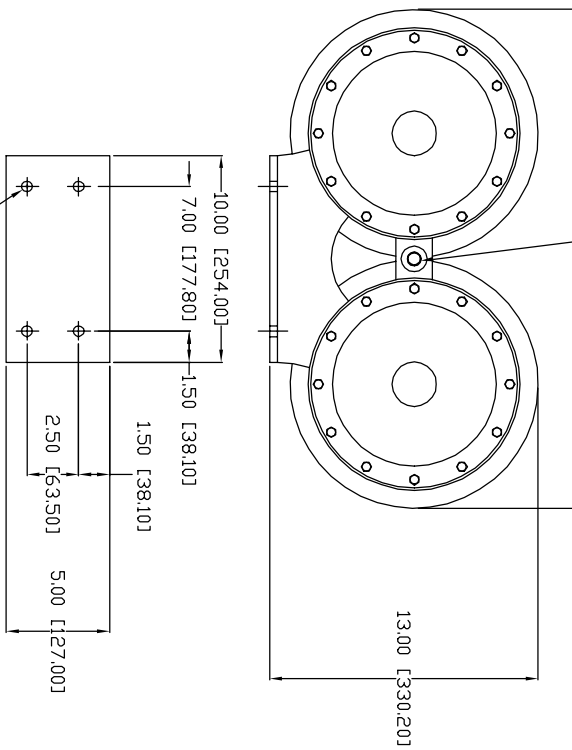
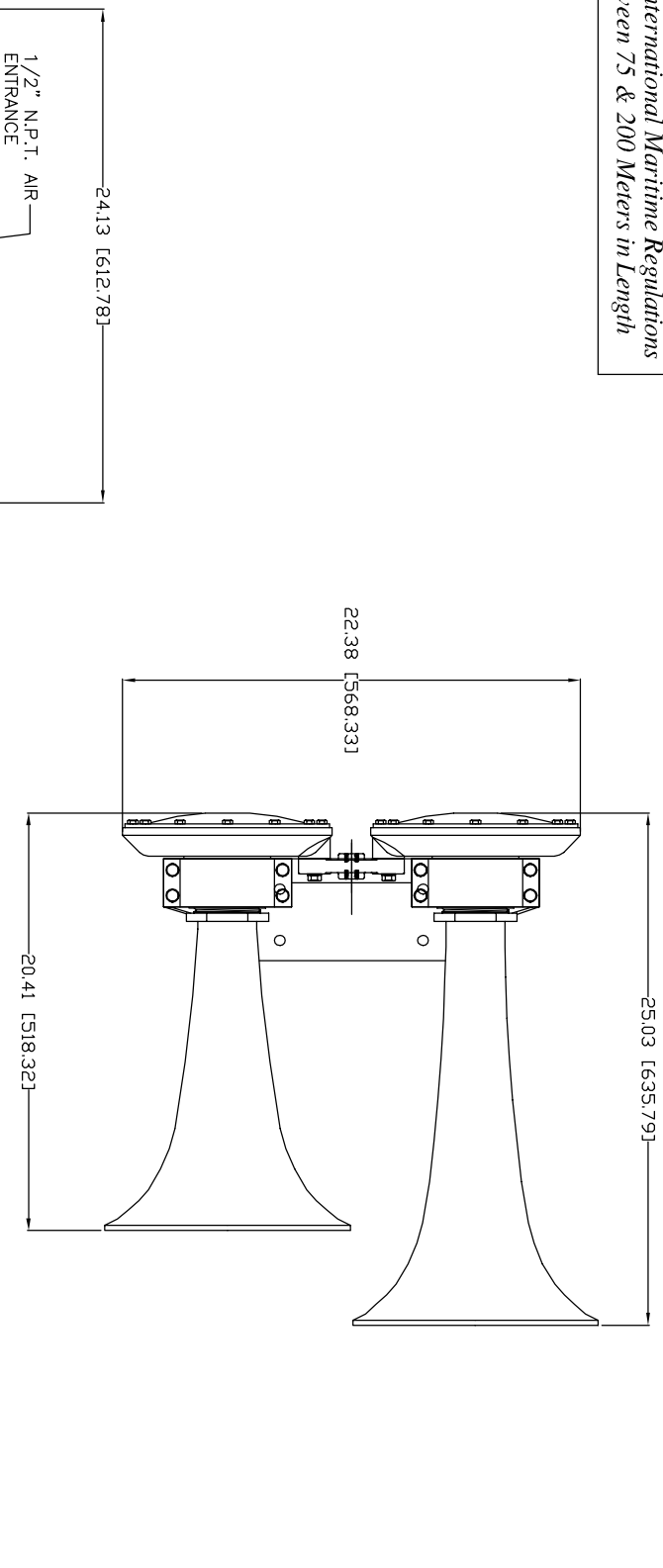

**TECHNICAL DATA**  
 Frequency: 177 Hz & 220 Hz  
 Sound Pressure Level (dB(A) at 1 meter): 143.2dB  
 Sound Pressure Level (1/3 octave at 1 meter): 138.3dB  
 Air Consumption: appx. 116 CFM @ 150 P.S.I.  
 Air Pressure Req: 100 To 250 P.S.I.  
 Electric Power: N/A  
 Material: Cast Bronze & Cast Aluminum  
 Finish: White Powdercoat  
 Net Weight: 145.00 Lbs.  
 Shipping Weight: 175.00 Lbs.

Price: \$ U.S.D. Net. Ea.  
 (Valid for 60 days, F.O.B. Two Rivers, WI. U.S.A.)



KAHLENBERG BROS. CO. TWO RIVERS, WI. U.S.A.

OUTLINE DIMENSIONS  
 MODEL D-4A AIRHORN  
 FIGURE 214-C

DATE	DRWG. NO.	REV.
05/14/01	3-5625	A EMK