

REV.	BY	DATE	DESCRIPTION	APP'D.
A	ZJN	03/01/11	REVISED WITH UPDATED BODY/STAND & COVER	EMK

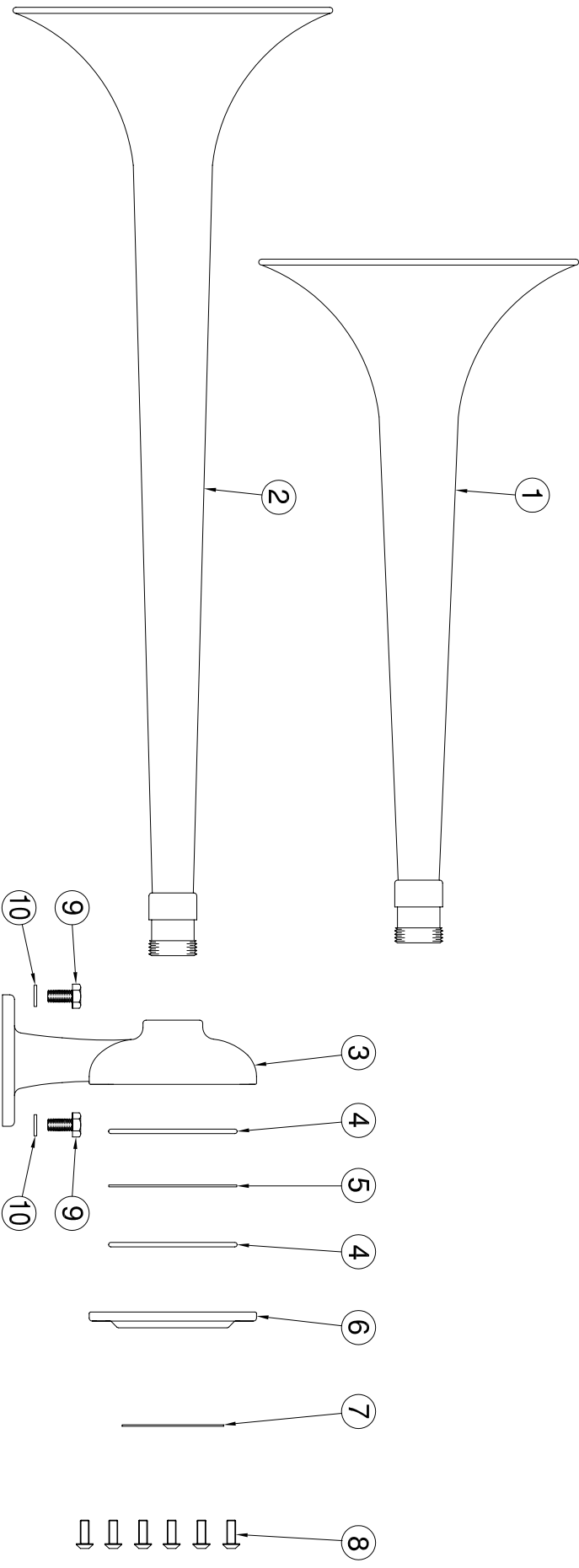

NO.	PART #	DESCRIPTION	DWG. #	REQ
1	P131-82 P131-82 CHROME P132-82 WHITE	PROJ. ASSEMBLY (BRASS) PROJ. ASSEMBLY (CHROME) PROJ. ASSEMBLY (WHITE)	3-6231	1
2	P131-84 P131-84 CHROME P132-84 WHITE	PROJ. ASSEMBLY (BRASS) PROJ. ASSEMBLY (CHROME) PROJ. ASSEMBLY (WHITE)	3-6233	1
3	P019-22 P019-22 CHROME P019-22 WHITE	BODY/STAND (BRASS) BODY/STAND (CHROME) BODY/STAND (WHITE)	3-6596	2
4	P321-17	O RING		4
5	P028-25	DIAPHRAGM	2-5495	2
6	P020-22 P020-22 CHROME P020-22 WHITE	COVER (BRASS) COVER (CHROME) COVER (WHITE)	3-6597	2
7	P133-01	NAMEPLATE		2
8	W102-003SS	SCREW, 10-24 X 1/2 BUTTON HD. CAP		12
9	W009-002BZ W009-002CH	SCREW, HEX HD 1/4"-20 X 5/8"		4
10	W011-002BZ W011-002CH	LOCKWASHER, 1/4"		4
11	P051-07	GASKET	2-5377	2
12	P026-64 P026-64 CHROME P026-64 WHITE	BRACKET/MANIFOLD		1

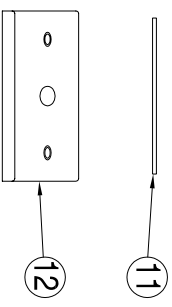

**CONFIDENTIAL**

INFORMATION CONTAINED HEREIN IS CONFIDENTIAL, IT IS THE PROPERTY OF KAHLEBERG INDUSTRIES INC. IT IS TO BE USED SOLELY FOR THE PURPOSE PROVIDED, AND IT IS NOT TO BE DISCLOSED TO OTHERS WITHOUT THE PRIOR WRITTEN CONSENT OF KAHLEBERG INDUSTRIES INCORPORATED.



KAHLEBERG INDUSTRIES INC. TWO RIVERS, WISCONSIN 54241

**PARTS LIST**

D-0A AIRHORN, FIG. 210  
AH/36237S/00000/NF (CH) (WH)

DR.	DATE	CKD.	SCALE	DRWG. NO.	REV.
ZJN	12/18/03	EMK	N.T.S.	3-6240	A